



Izerwaren order numbers

Stainless steel dogging devices
• seawater resistant

- 44.221 Toggle device (221) Left hand (depicted in picture)
44.222 Toggle device (222) Right hand
Light duty
Lever: 110 mm - 4 5/16"
distance brackets: 75 mm - 3"
Polished 304 stainless steel

ORDER SEPARATELY:

- 43.141 Strike plate with lip
100 x 28 mm 316 stainless steel
43.943 Strike wedge
3 3/8"x 3/4"x 3/4"
85 x 20 x 20 mm
304 stainless steel.

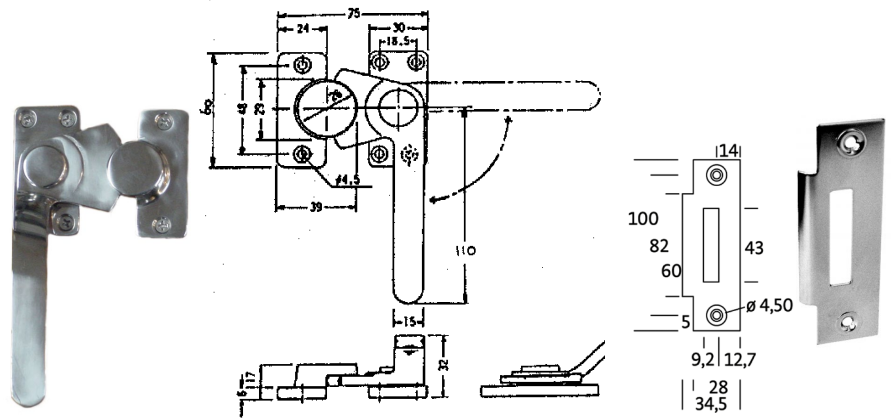

Left Hand Right Hand
#44.221 304 stainless steel dogging device for hatches & doors. Strike 43.141 with lip
#43.141 Strike with lip: 28 x 100 x 1.5 mm. Allows for angle mounting

Toggle device
Extra heavy duty
316 stainless steel door toggle,
both sided
aluminum bush with nylon bearing
with 1/8" hole for grease nipple
lever 6 1/2"; total 9 1/2" long,
bush OD: 45 mm 1 25/32" Ø
with aluminum bush 73 mm long

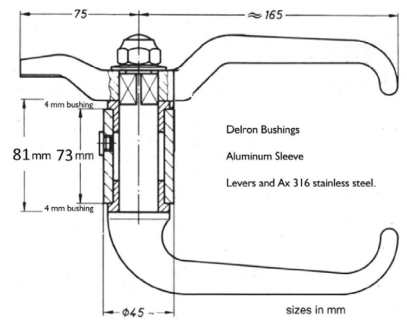
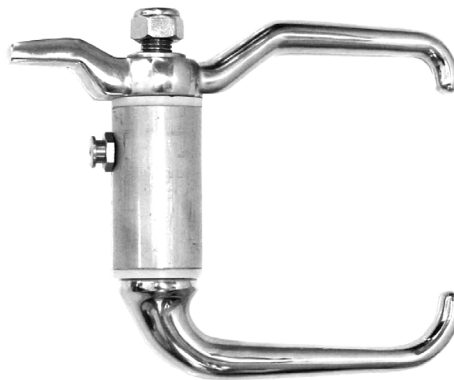

#44.941 | Extra heavy duty 316 stainless steel door dogging device with aluminum bushing 73 mm

44.9411 #44.9411 see page 4-4-A

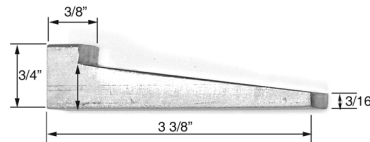

44.9412 #44.9412 see page 4-4-B

#44.943 Strike wedge weld on type for door dogging device



44.9413 #44.9413 see page 4-4-C



44.9404 #44.9404 see page 4-4-D

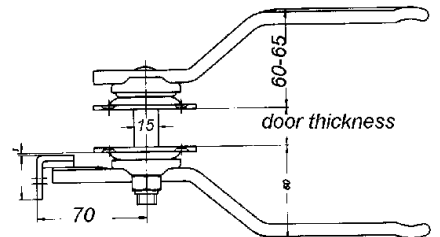

#44.131 Door toggle; double sided, for door thickness: 42 mm or 1.75 inch; Medium duty.

44.130 Toggle device, single sided
Medium duty
304 stainless steel door toggle,
See page 4-4-0-H

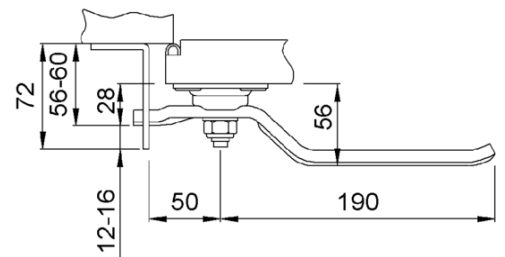
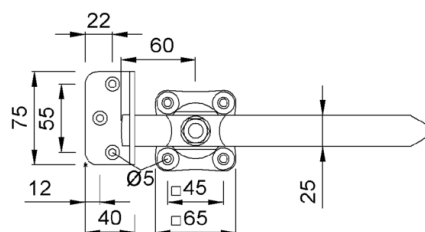

#44.130 Door toggle; single sided with angle strike plate. 304 stainless steel

44.131 Toggle device, double sided
Medium duty
304 stainless steel door toggle,
See page 4-4-0-H